

## Zale Cu Atașament WA-2

### 80 WA2 Attachment Link Dimensions

<b>Pitch (P):</b>	1"
<b>Link Plate Thickness (T):</b>	0.125"
<b>Tab Width (G):</b>	1.807"
<b>Hole Spacing (G1):</b>	1.000"
<b>Centerline To Outer Attachment Width (W):</b>	1.441"
<b>Width To Center Hole (F):</b>	1.000"
<b>Attachment Hole Diameter (d4):</b>	0.268"
<b>Attachment Height (h4):</b>	0.625"
<b>Connecting Link Clip Type:</b>	Spring Clip
<b>Chain Material:</b>	Carbon/Alloy Steel
<b>Industry Standard:</b>	ANSI B29.1 ⓘ

All dimensions listed are nominal values.

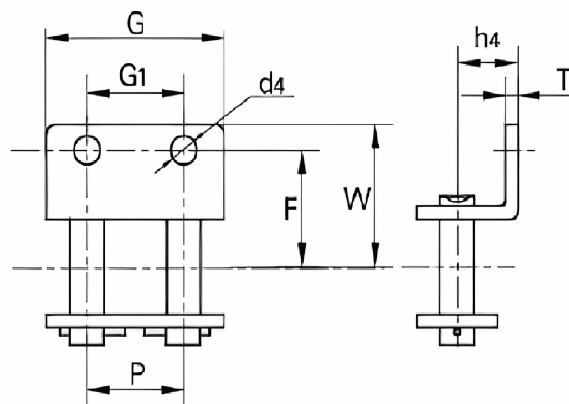

## Installation

### Connecting Link Installation Tips

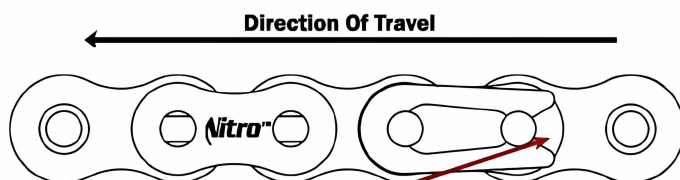

#### Spring Clip Connecting Links:

The spring clip should be installed where the opening is facing away from the direction of travel. This will help prevent the spring clips from coming off. Like shown in the diagram to the right.

*Careful not spread the clip opening too far apart. This can make the clip more prone to falling off.*

#### Cotter Pin Connecting Links:

Cotter Pin Connecting Links The cotter pins pin legs should be spread about 60° apart. Like shown in the diagram to the left.

*Never reuse cotter pins that have been taken off. Never use commercial cotter pins as these are usually not hardened.*

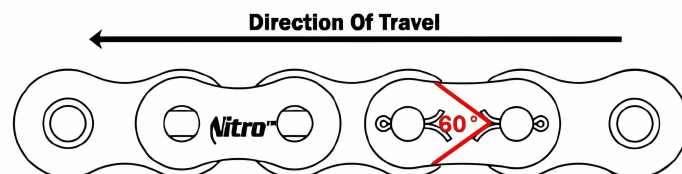

Zale patent cu atașament îndoite orizontal, din oțel cu clemă elastică.

Cu ajutorul acestui tip de zală puteți prinde diferite obiecte(cutii, benzi etc.).



0726.175.111  
0721.228.444  
0754.075.656

COMPONENTE PNEUMATICE ȘI HIDRAULICE  
COMPONENTE ELECTRICE  
COMPONENTE MECANICE



AUTOMATIC INVEST  
ROMANIA, IAȘI,  
CALEA CHIȘINĂULUI, NR. 29



WWW.AUTOMATIC.RO  
EMAIL  
VANZARI@AUTOMATIC.RO